

wiba®
100% Wireless Power Bank



**GOODBYE
CABLES.
HELLO
WIRELESS
CHARGING.**



wiba[®]

100% Wireless Power Bank



Thank you for purchasing the Avido WiBa 100% wireless power bank. For optimal performance, please follow the detailed instructions within this manual. Note: Avido is not liable damages due to product misuse.

WE HOPE YOU ENJOY!



Important Information

- Before using the wireless features of WiBa, make sure your device is Qi wireless compatible. Compatible devices include the iPhone 8, 8 Plus, X, variants of the Samsung S9, S8, S7, S6, Note 8, and many more. Please consult with your phone manufacturer to confirm.
- Please note that sensors in phones such as the LG G6 & Droid 2 Turbo will lock the screen if they detect magnets. WiBa can still charge these devices, but the screen is unusable when connected to WiBa power bank.
- Only use the Avido authorized accessories included in this package. Replacements can be purchased at AvidoPower.com or by emailing support@avidopower.com.

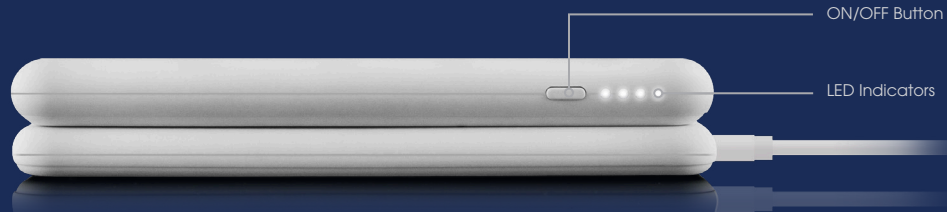

All About WiBa



What's in the Box

- WiBa 100% Wireless Charging Power Bank
- WiBa Wireless Charging Pad
- QC 3.0 AC Adapter
- 2 Metal Plates (Black & Silver)
- USB Type-C Cable

Key Features

- **Simultaneously charge your Qi device and power bank, 100% wirelessly**
 - Just stack your phone and power bank on the charging pad
- **Fast Charge compatible charging pad**
 - Charging pad charges power bank OR Qi compatible phone
- **Up to 2x charges on-the-go**
 - 5000mAh provides extended charge
- **Optional metal plates included**
 - Keep your phone magnetically attached to the power bank

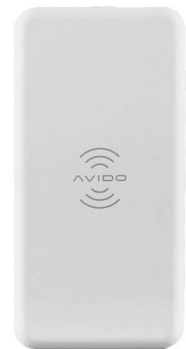

WiBa 100% Wireless Charging Power Bank

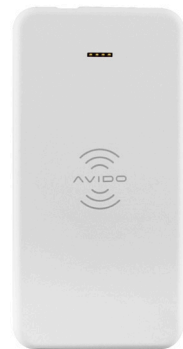

WiBa Wireless Charging Pad



QC 3.0 AC Adapter

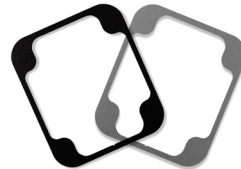

2 Metal Plates (Black & Silver)



USB Type-C Cable

Charging Your Device

Wireless Charging

WiBa power bank can wirelessly charge any Qi device.

To start:

1. Press the "ON/OFF" button once and place your device on top of WiBa power bank. Make sure that your device is aligned on WiBa.
2. The LED light on the left side of the unit will illuminate green indicating wireless charging has been activated. If your phone is removed or no compatible device is detected within 30 seconds, the LED light will turn off and the unit will automatically shut off the wireless charging feature. You can also manually turn off WiBa by double tapping the "ON/OFF" button.



Wired Charging

1. Connect the cable that came with your device to WiBa's USB output port. Press the "ON/OFF" button to begin charging.
2. If no device is plugged in, the LED lights will turn off and the unit will automatically shut off the wired charging feature. You can also manually turn off WiBa by double tapping the "ON/OFF" button.

You can charge a wireless and wired device at the same time.



Recharging WiBa / Qi Device

Wireless Charging

1. To recharge WiBa with the charging pad, use the supplied USB Type-C cable and AC adapter. Plug the AC adapter directly into a wall or surge protector and plug the USB cable into the charging pad input port.
2. Place WiBa power bank on top of the charging pad. Magnets will automatically guide WiBa to a secure fit. The LED lights on the right side of the unit will illuminate and blink indicating the charge level.
3. If desired, stack your Qi device directly on top of WiBa power bank. Your device and WiBa power bank will begin charging simultaneously.



Wired Recharging

1. To recharge WiBa with a cable, use the supplied USB Type-C cable and AC adapter. Plug the AC adapter directly into a wall or surge protector and plug the USB cable in WiBa power bank's input port. LED lights on the right side of the unit will illuminate and blink indicating the charge level.
2. If desired, stack your Qi device directly on top of WiBa power bank. Your device and WiBa power bank will begin charging simultaneously.



A close-up photograph of a person's hand using a silver laptop. The laptop is resting on a grey, perforated desk mat. To the right of the laptop, a black smartphone is placed on a white wireless charging pad. The phone's screen is lit up, showing a green circular progress indicator with the text '100%' and a lightning bolt icon, indicating it is fully charged. A white charging cable is plugged into the top of the phone. The person's hand is wearing a gold-colored, textured sleeve.

**POWER
WHEN
YOU NEED
IT MOST.**

Recharging WiBa / Qi Device (Notes)

- **Only use the supplied AC adapter for recharging WiBa.** For best results, do not plug WiBa into a computer's USB port.
- WiBa power bank can only be recharged wirelessly using the Avido WiBa charging pad. Do not attempt to place WiBa on a standard Qi wireless charging pad.
- Do not plug in a wired device to WiBa while the power bank is recharging. Only a wireless device and WiBa power bank can charge simultaneously.
- Do not stack multiple Qi devices on the power bank or charging pad.
- Charging times will vary based on device and/or current charge level.

Charging Your Device on the Charging Pad

WiBa's charging pad is Fast Charge compatible and can wirelessly charge your device directly.

1. Use the supplied USB Type-C cable and AC adapter. Plug the AC adapter directly into a wall or surge protector and plug the USB cable into the charging pad input port.
2. Place the wireless device on the wireless charging pad. Make sure the center of the device is aligned over the center of the charging base. Charging will begin on contact.

Notes

- Only use the supplied AC adapter. For best results, do not plug into a computer's USB port.
- A Fast Charge compatible device is required to take advantage of up to 10W of wireless power.

Checking WiBa's Charge Level

Tap the "ON/OFF" button once on your WiBa power bank and the status LEDs will indicate its charge level. Four LEDs indicate that WiBa's battery is fully charged, while one LED means that it's almost out of power.

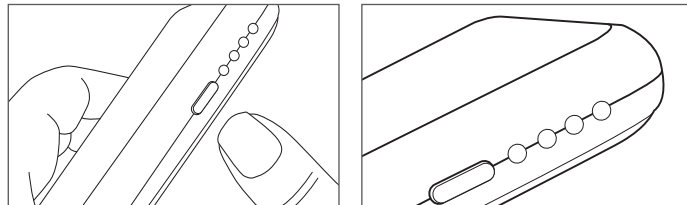

Please read important notes on the next page

Optional Metal Plate Installation

In most cases, a stable wireless charge connection can be found at the center of a phone.

1. Place and hold your Qi-enabled phone on the center of WiBa power bank and very slowly move your phone until a charging connection is found.
2. Before adhering the metal plate, take note of the area on the device that receives a charging connection from WiBa power bank.
3. Peel the adhesive cover off the metal plate and press firmly onto your phone or inside your case.
4. Once the metal plate is affixed, place the device onto the WiBa power bank to make it is charging properly.

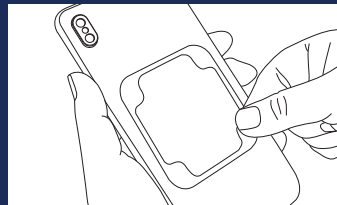
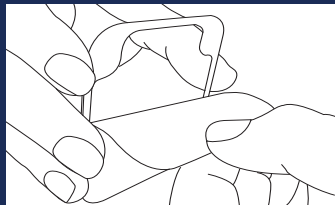

Notes *(Continued from previous page)*

- We strongly recommend first applying the included adhesive film to the back of your Qi device or phone case before applying the metal plate. This specifically applies to users of iPhone X/8/8 Plus and any device featuring an all glass back.
- We strongly recommend placing the metal plate to the back of your smartphone or, if using a case, to the outside of the phone case. This will ensure a much stronger hold on WiBa's power bank.
- Please note, even though the metal plate assists your device in staying attached to WiBa, excessive movement can cause your phone and WiBa to separate.

Specifications

	Charging Pad	Power Bank
Size (Dimensions)	5.47" x 2.81" x 0.39"	5.47" x 2.81" x 0.57"
Weight	5.7 oz	5.3 oz
Charging Technology	Qi Output	Qi Output
Input Type	Type-C	Type-C
Max Input	5V / 2.1A	5V / 2A
Capacity	N/A	5000mAh, 18.5Wh
No. of USB Charging Ports	N/A	1
Wireless Output	9V / 10W	5V / 5W
Wired Output	N/A	5V / 2.1A

Taking Care Of Your WiBa

Important Notes

- Keep your WiBa power bank and charging pad dry and away from moisture and corrosive materials.
- Do not clean your WiBa with harsh chemicals, soaps or detergents. Just wipe with a soft, water dampened cloth.
- Make sure WiBa's USB ports do not become contaminated with lint or other debris. Use a canned-air type of product periodically to ensure that the port openings are clear.
- Recharge your WiBa power bank once every three months when not in use. If you plan on putting it away, fully charge it first.

Warranty

At Avido, we know how important it is to keep your mobile life moving. This product is warranted for 1 year from date of purchase. Keep a copy of your purchase receipt as proof of purchase. Be sure to register your product at avidopower.com. Failure to register your product and/or provide proof of purchase may void the warranty. This warranty does not cover accidental damage, wear and tear, or consequential or incidental loss.

Warnings

Read all instructions and warnings prior to using this product. Improper use of this product may result in product damage, excess heat, toxic fumes, fire or explosion, for which damages you ("Purchaser"), and not Avido, LLC ("Manufacturer") are responsible. This product contains magnets. To reduce the risk of interference with other electrical equipment, consult your doctor and/or device manufacturer before using this product if you have a pacemaker or other implanted electrical devices.

- Only use the included components for an optimal experience.
- During the charging process, the transfer of electricity gives off heat. Your device may become warm, but should not become exceedingly hot.
- Do not store device in high-temperature environment, including heat caused by intense sunlight or other forms of heat. Do not place device in fire or other excessively hot environments.
- Be cautious of excessive drops, bumps, abrasions, or other impacts to this device. If there is any damage to the device such as dents, punctures, tears, deformities, or corrosion due to any cause, discontinue use. Contact Manufacturer or dispose of it in an appropriate manner at your local battery-recycling center.
- WiBa should be operated only in open-air conditions. Failure to follow these instructions may cause damage to WiBa by overheating.
- Do not disassemble this device or attempt to re-purpose or modify it in any manner.
- Do not attempt to replace any part of this device.
- If this device is intended by Purchaser to be used by a minor, purchasing adult agrees to provide detailed instructions and warnings to any minor prior to use. Failure to do so is sole responsibility of Purchaser, who agrees to indemnify Manufacturer for any unintended use/misuse by a minor.

Notes *(Continued from previous page)*

- All products have gone through a thorough quality assurance inspection. If you find that your device is excessively hot, is emitting odor, is deformed, abraded, cut or is experiencing or demonstrating an abnormal phenomenon, immediately stop all product use and contact Manufacturer.
- Never dispose of batteries in the garbage. Disposal of batteries in the garbage is unlawful under state and federal environmental laws and regulations. Always take used batteries to your local battery-recycling center.

Legal

This product is meant for use only in conjunction with the appropriate device. Please consult your device packaging to determine whether this product is compatible with your particular device. Manufacturer is not responsible for any damages to any device incurred through the use of this product. Manufacturer shall not in any way be liable to you or to any third party for any damages you or any third party may suffer as a result of use, intended or unintended, or misuse of this product in conjunction with any device or accessory other than the appropriate device for which this product is designed. Manufacturer will not be responsible for any damages you or any third party may suffer as a result of misuse of this product as outlined above. If you are responsible for product use with an unintended device and damages result from such use, you agree to indemnify Manufacturer for any resulting injuries to any third part(ies).

California Proposition 65

This product contains chemicals known to the state of California to cause cancer and birth defects or other reproductive harm.

Declaration of Conformity (FCC)

FCC ID: 2AQQFKLWIBAPB, 2AQQFKLWIBADOCK
This device complies with Part 15 of the FCC Rules:

1. This device may not cause harmful interference, and
2. This device must accept any interference received, including interference that may cause undesired operation.

Changes or modifications not expressly approved by the party responsible for compliance could void the user's authority to operate the equipment.

Questions?

Our Customer Service Team is here to help! Please reach out to us at support@avidopower.com.

Connect With Us



@AvidoPower

@AvidoUSA



AVIDO

avidopower.com